

# FIXTURE & FURNISHING PLAN

家具平面圖 SCALE 1:25@A1,1:50@A3

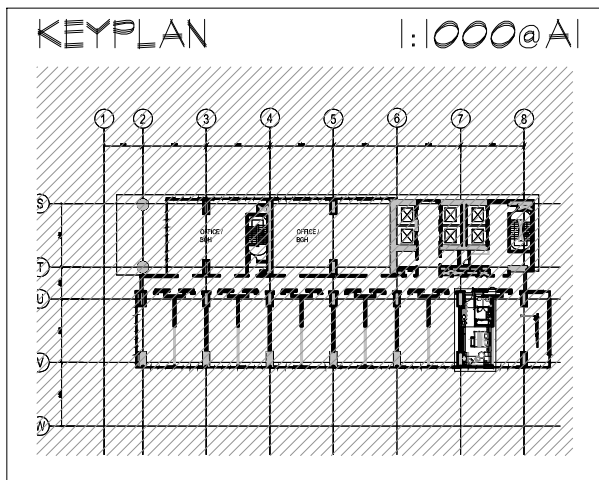
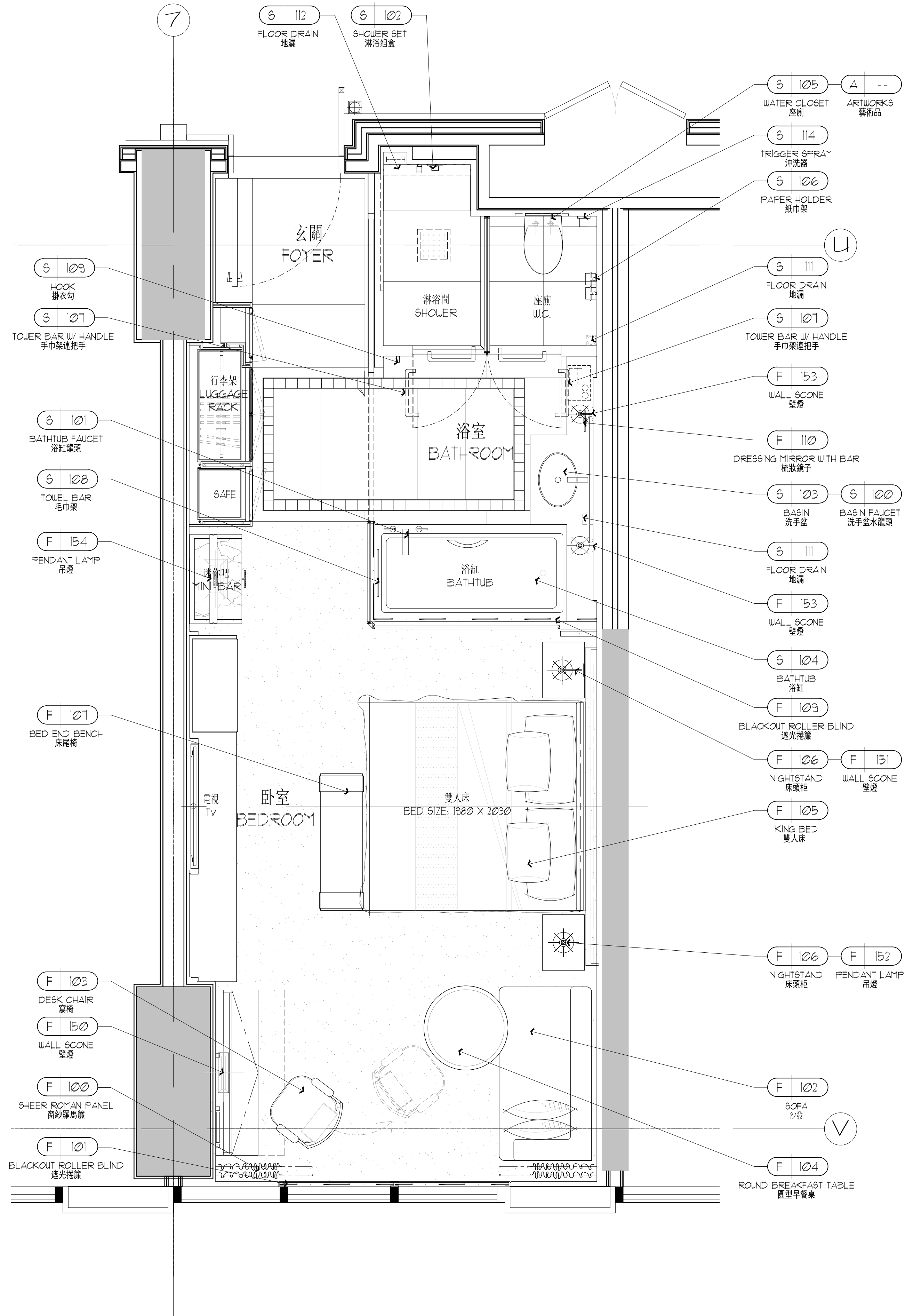

FOR TENDER  
DATE: 15 MAR 2016

仰光泛太平洋酒店

PAN PACIFIC  
YANGON, MYANMAR

REVISION	DATE
△	17 JUL, 2015
△	06 AUG, 2015
△	14 SEP, 2015
△	16 NOV, 2015
△	17 NOV, 2015
△	15 MAR, 2016

CLIENT建設單位

ALL DESIGNS AND SPECIFICATIONS ARE THE PROPERTY OF CHENG CHUNG DESIGN (HK) LTD. AND CANNOT BE USED WITHOUT THEIR WRITTEN PERMISSION. THE SAME SHALL BE RETURNED UPON COMPLETION OF THE PROJECT. DO NOT SCALE DRAWINGS. ALL MEASUREMENTS MUST BE CHECKED ON SITE BY THE CONTRACTORS AND ANY DISCREPANCIES BROUGHT TO THE ATTENTION OF THE DESIGNER OR ARCHITECT. THIS DRAWING IS TO BE USED FOR THE PROJECT AND SITE IDENTIFIED AND NOT TO BE USED ON ANY OTHER PROJECT.

CCD  
ChengChung Design  
香港鄭中設計事務所

CHENGCHUNG DESIGN (HK) LTD.  
27F, CNT TOWER, NO. 338 HENNESSY ROAD  
WAN CHAI, HONG KONG  
TEL. NO. +852-2548-2009 FAX. NO. +852-2548-2089  
E-MAIL: DESIGN@CCD.COM.HK  
DRAWING TITLE圖名

GUESTROOM AREA - 客房部份  
L7M MOCK UP ROOM - 七夾層樣板房  
DELUXE KING - 標堆大床房  
FURNITURE & FURNISHING PLAN - 平面佈置圖

DESIGN NO. 設計編號: HK-1410  
PROJECT DIRECTOR 設計總負責人: PH  
DESIGNED BY 設計: PH DRAWN BY 繪圖: PH  
PROCESSED BY 審核人: PH  
CHECKED BY 校對人: PH APPROVED BY 核准: PH  
DISCIPLINE 專業: BK/JB STATUS 階段: INTERIOR DESIGN TENDER  
SCALE 比例: 1:25 @ A1 DATE 日期: 19 JUN, 2015  
SHEET NO. 圖號:

FF-DK-2